

# Wichita<sup>TM</sup> Silhouette Pistol

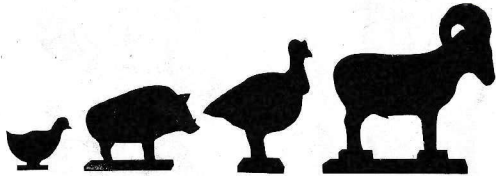

## Owner's Manual and Parts List

### **Wichita Arms**

333 Lulu, P.O. Box 11371, Wichita, Kansas 67211  
(316) 265-0661

A Division of Wichita Engineering & Supply, Inc.

## NOTICE TO CONSUMER

The merchandise enclosed has been inspected and found to be merchantable and meeting specifications set by the manufacturer.

A Bill of Lading or Waybill attached indicates that material shipped has now become **your property** and is an acknowledgement by the Transportation Company of the receipt of the material in good condition.

Any damage done during the shipment becomes the **responsibility of the carrier**.

Claims for loss due to damage or shortage must be made promptly with the carrier. Do not deduct claims for loss or damage or transportation charges resulting therefrom from our invoice, nor payment of invoices to be withheld awaiting adjustment of such claims, since it is the function of the carrier to guarantee safe delivery.

At the time of claim, notify the manufacturer of damage or loss.

For damaged or lost merchandise received without benefit of Waybill or Bill of Lading by the carrier, notification of the manufacturer must be expedient. Packaging, packing list and/or invoice must be retained for payment until such time manufacturer has instructed further as to method of tracing, returning merchandise for credit or repair, and/or credit allowance.

Claims for merchandise received damaged in transit must be made within (7) days of receipt of merchandise or claim will be void for this damage.

## STATEMENT OF LIABILITY

This gun is classified as a **firearm** or **dangerous weapon** and is surrendered by Wichita Arms with the express understanding that it assumes no liability to any person other than the purchaser registered with the selling dealer; no liability resulting from unsafe handling, no liability arising from conduct constituting a violation under any applicable laws or regulations, nor any other liability except as expressly provided in implied warranties. Wichita Arms shall not be liable for personal injury (A) intentional, reckless, negligent, or accidental discharge; (B) the function of any gun subject to influence beyond its control which may result from careless handling, improper usage, corrosion or neglect; (C) unauthorized adjustments, repairs or alterations made outside the factory; (D) the incorporation of any part not of its manufacture; or (E) defective, improper, or reloaded ammunition. Wichita Arms will not be liable for any injury or damages to any person arising out of use of this firearm in hunting dangerous game, combat, civil defense, competition, or police activities. This statement of liability supercedes any other statements of liability, whether expressed or implied.

## WICHITA SILHOUETTE PISTOL

Your Wichita Silhouette Pistol is manufactured from the finest material available. As with any product, certain care and maintenance should be provided to maintain your pistol in its original condition.

## **WHY NO WARRANTY CARD HAS BEEN PACKED WITH THIS WICHITA FIREARM**

As a result of the confusion following passage of the Magnuson-Moss Warranty — Federal Trade Commission Improvement Act (Public Law 93-637) Wichita Arms discontinued packing warranty cards with firearms.

The Magnuson-Moss Act does not require any seller or manufacturer of a consumer product to give a written warranty. It does provide that *if a written warranty is given*, it must be designated as “limited” or as “full” and sets minimum standards for a “full” warranty.

Wichita Arms has elected not to provide any written warranty, either “limited” or “full”, rather than to attempt to comply with the provisions of the Magnuson-Moss Act and the Regulations issued thereunder.

The Uniform Code specifies certain *implied warranties* which accompany every sale of consumer goods. These include a warranty that the goods are merchantable and that they are fit for the purpose for which required by the buyer.

Wichita Arms will continue to honor these implied warranties and wishes to assure its customers of its continued interest in providing service to owners of Wichita firearms.



### **WARNING**

A safety **is not** provided on the Wichita Silhouette Pistol. Do not perform any maintenance, cleaning or adjustment on your pistol without first determining that your pistol is unloaded.



## **GENERAL DISASSEMBLY AND ASSEMBLY**

### **Bolt:**

To remove the bolt from the receiver, depress the lever, on the side of the receiver, ahead of the rear sight, and while depressed remove bolt by pulling the bolt to the rear, until it is clear of the receiver. The lever must also be depressed to install the bolt into the receiver.

### **Barrelled Action:**

To remove the barrelled action from the stock, it is necessary to remove two (2) bedding screws. One is located directly behind the trigger, the other screw is located midway between the grip and the rear of the stock. Caution must be exercised when setting action back into stock to align the trigger link in its slot. Failure to align this link correctly may bend it causing less sear engagement than desired. After removal of these two screws the barrelled action may be removed from the stock by lifting it upward. Resistance may be felt due to the extremely close bedding provided in the pistol.

To reinstall the barrelled action in the stock, align the barrelled action in the stock and gently push in downward until it is seated in the bedding. Install the two (2) bedding screws finger tight, making sure the two



washers, one under each screw, are in place. Tighten the bedding screws evenly starting with the front screw.

### **Trigger:**

The trigger, trigger link and the trigger mechanism must be removed as a unit. Remove two (2) screws, which retain the trigger bracket to the recoil lug. Remove the two (2) cross pins, which retain the trigger mechanism to the receiver, by using a suitable punch and hammer, being careful not to damage the mechanism or the receiver. Do not bend the trigger link in any way. The slightest bend is reflected in a decrease in sear engagement and lightens the trigger pull accordingly.

### **Bolt Disassembly:**

- 1) Remove bolt from the receiver.
- 2) Insert a  $\frac{1}{8}$ " pin into the shroud to pry the cocking block to the rear. A  $\frac{1}{16}$ " is all that is necessary.
- 3) Holding the cocking block in this position, unscrew the shroud to remove the shroud and firing pin assembly from the bolt body. A right hand bolt has left hand threads, and a left hand bolt has right hand threads.
- 4) Loosen the set screw (No. 12) which retains the cocking block (No. 11) to the firing pin (No. 8). Unscrew the shroud (No. 10) from the firing pin (No. 8). (Refer to Drawing # WSP0046)
- 5) Thoroughly clean all parts and wipe with a light film of oil. Lubricate the following points with one or two drops of light oil or dry lube material: Collar on firing pin, threads on firing pin, hole in shroud where firing pin passes through and threads on shroud.
- 6) To reassemble the bolt, place the firing pin spring (No. 9) over the firing pin (No. 8). Place the cocking block (No. 11) into the shroud (No. 10). Insert the firing pin (No. 8) into the cocking block (No. 11) until about flush with the rear of cocking block (No. 11). Insert the  $\frac{1}{8}$ " pin into the shroud as far as possible. Remove  $\frac{1}{8}$ " pin from shroud (No. 10) and let cocking block tip extend into the V-notch of the bolt body (No. 7) as in the fired position. Measure the firing pin protrusion at the bolt face .058. If this dimension is not correct, remove the firing pin and shroud assembly from the bolt body and adjust by grasping the firing pin collar (No. 8) and screwing it into the cocking block (No. 11) to **decrease** the protrusion. Unscrew the firing pin (No. 8) from the cocking block (No. 11) to **increase** the protrusion. When the correct dimension is obtained, tighten set screw (No. 12) and place the cocking block in the cocked position on the bolt. The bolt is now ready to reinstall into the receiver. (Refer to Drawing # WSP0046)

### **CARE AND CLEANING**

- 1) Remove bolt from the receiver.
- 2) Using a clean cloth patch and a good powder solvent, swab the bore several times. If residue still remains, use a brass or bronze brush of the correct caliber, and clean the bore. Again swab the bore with a cloth patch soaked in powder solvent. Thoroughly swab until the bore is clean. Run dry patches through the bore until all the solvent is removed. Using a clean patch and a small amount of oil, light oil the bore for storage.

3) Clean all interior and exterior surfaces using a clean cloth and a small amount of oil.

4) Clean the bolt in the same manner. Make sure there is no obstruction or powder residue on the bolt face or under the extractor.

5) Apply a drop of lubricant to all pivot points of the trigger mechanism and trigger. Also apply a drop of lubricant to the extractor and the ejector pin located in the bolt face. Wipe all excess lubricant from these points. We recommend the use of light oil or dry lube material.

6) When reinstalling the bolt apply a drop of lubricant to the rear edge of each locking lug and to the tip of the cocking block.

7) Do **not** apply excessive oil or lubricant. A thin film of oil on all surfaces is adequate protection. A drop of lubrication on all points specified is adequate to insure proper functioning. An excessive amount of oil or lubrication tends to gather dust and dirt which can interfere with the safe and reliable function of the firearm. **Dry chamber and bore before firing.**

### TRIGGER ADJUSTMENT

The trigger has two (2) adjustments. These are sear engagement and over-travel. These are pre-set at the factory but may be changed to suit the individual. The sear engagement is set first. Turn Screw **A** clockwise to **decrease** engagement. Turn Screw **A** counter-clockwise to **increase** sear engagement. Trigger over-travel may then be set. Turn Screw **B** clockwise to **decrease** over-travel. Turn Screw **B** counter-clockwise to **increase** over-travel.

**CAUTION:** Too little sear engagement could cause an unsafe condition.

### SIGHTS AND ADJUSTMENT

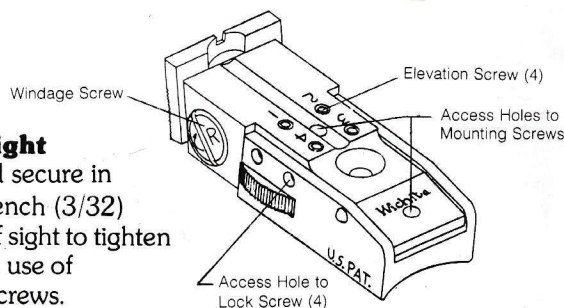

#### Installation of Rear Sight

Position sight on gun and secure in place by inserting Allen wrench (3/32) through two holes on top of sight to tighten screws. We recommend the use of Loc-tite on the mounting screws.

#### How to Adjust Sight Setting

- 1) Always turn serrated wheel clockwise.
- 2) To preset #1 position, turn wheel so a number is not visible.
- 3) Loosen lock screw #1.
- 4) Turn #1 elevation screw to desired position, then tighten #1 lock screw.
- 5) Turn wheel to #1 position and check to see if it is the elevation you desire. If it needs changing go through the same procedure again. If it is where you want, then proceed to #2, #3, and #4 positions.

#### Windage Screw

Turn the windage screw to the right to move your bullet to the right. The windage screw and nut are wedged together to remove all slack.

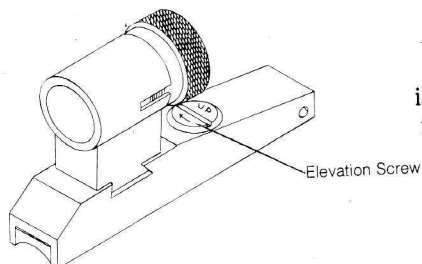

Your New Wichita Arms  
Adjustable Front Sight  
is capable of compensating  
for daily range conditions.

### **Installation of Front Sight**

To mount the sight, remove the elevation screw and swing the ramp up to expose the base. Insert two screws and tighten. We recommend the use of a locking agent on the screws.

### **Adjusting the Sight**

To change elevation, turn the elevation screw located on the top of the sight.  
NOTE: A high point of impact at maximum height adjustment of front sight, indicates a need for additional globe height.

### **STOCK**

The stock will either be Fiberthane or American walnut.

The fiberglass stock may **not** be modified without damaging the finish. If modifications are made it will be the responsibility of the owner.

The wood stock may be modified to some extent in the grip area. A small amount of wood may be removed from the grip area to custom fit your hand. The bottom portion of the grip is hollow. Proceed with caution when removing wood from the grip of your pistol. Removing too much wood from the grip will cause you to cut into the hollow portion of the grip. If this occurs, we cannot be responsible for your stock. If you do remove wood from your stock, the finish may be refinished using Lin-Speed stock finish. (Refer to Drawing # WSP0047)

CAUTION: It is not necessary to put excessive torque on bedding bolts. These bolts draw the action into a fully bedded stock. Unnecessary torque will result in damage to the stock and possible breakage.

### **DRY-FIRING**

Do **not** dry-fire this firearm without a suitable device, such as a snap-cap or similar device, as damage could result.

### **CAUTION**

1) Firing the pistol with any obstruction in the barrel may result in severe damage to the pistol and serious injury to the shooter. Always check your barrel for an obstruction if you experience difficulty in chambering a cartridge, experience a failure to extract, have a misfire, or the pistol does not make a normal loud report on firing.

2) Do not touch the trigger until you are actually ready to fire.

3) After periods of storage, before firing, remove all oil and grease from the bore, with clean dry patches.

4) It is the Purchaser's responsibility to be absolutely certain that any parts ordered from the factory are correctly fitted and installed. Firearms



are complicated mechanisms and improper fitting of parts may result in a dangerous malfunction, damage to the firearm and possible injury to the shooter and bystanders.

5) If you return the firearm to the manufacturer for repair or modification, be certain that the firearm is not loaded. It is a violation of Federal law to ship a loaded firearm.

6) A locking agent is used on the sear adjustment set screw [A] (Drawing WSP0020). It may be necessary to heat the screw in order to soften the agent, thus avoiding damage to the .035 Allen socket head screw.

DRAWING WSP0046

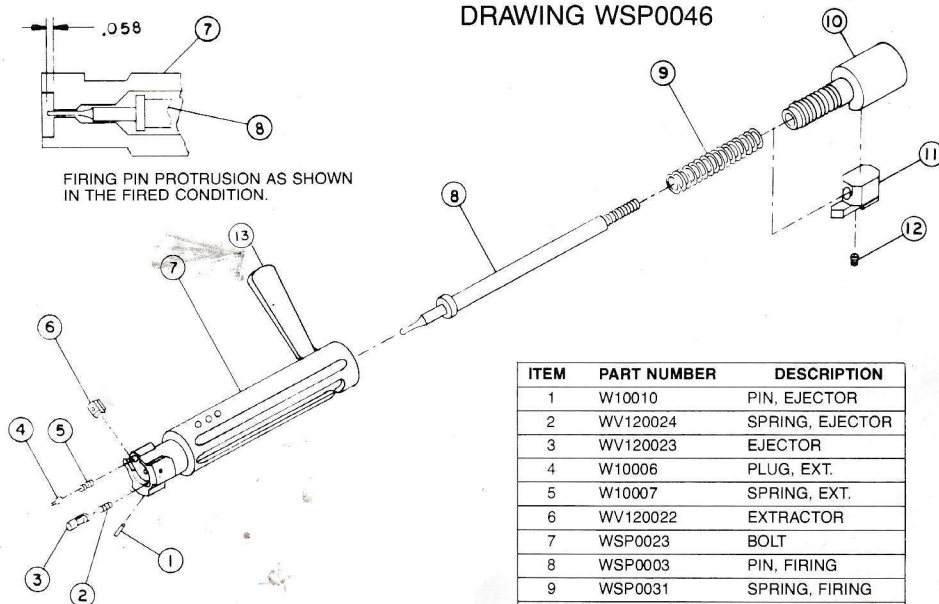

ITEM	PART NUMBER	DESCRIPTION
1	W10010	PIN, EJECTOR
2	WV120024	SPRING, EJECTOR
3	WV120023	EJECTOR
4	W10006	PLUG, EXT.
5	W10007	SPRING, EXT.
6	WV120022	EXTRACTOR
7	WSP0023	BOLT
8	WSP0003	PIN, FIRING
9	WSP0031	SPRING, FIRING
10	WSP0004	SHROUD
11	WSP0005	BLOCK, COCKING
12	WSP0045	SCREW, SET
13	WSP0015	BOLT HANDLE

- (1) R.H. ASSY. SHOWN, L.H. SAME BUT OPPOSITE.  
 (2) SHROUD (10): R.H. BOLT, H.H. THDS.: L.H. BOLT, R.H. THDS.  
 (3) WHEN ORDERING BOLT OR EXTRACTOR STATE CALIBER.  
 (4) WHEN ORDERING COCKING BLOCK (11) STATE RIGHT OR LEFT HAND BOLT.

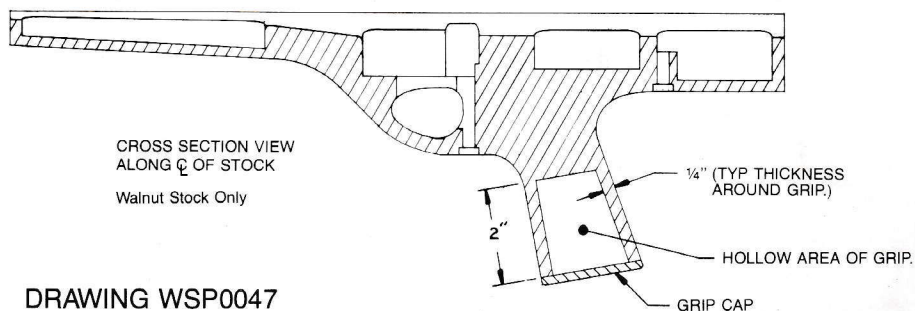

DRAWING WSP0047

DRAWING WSP0018

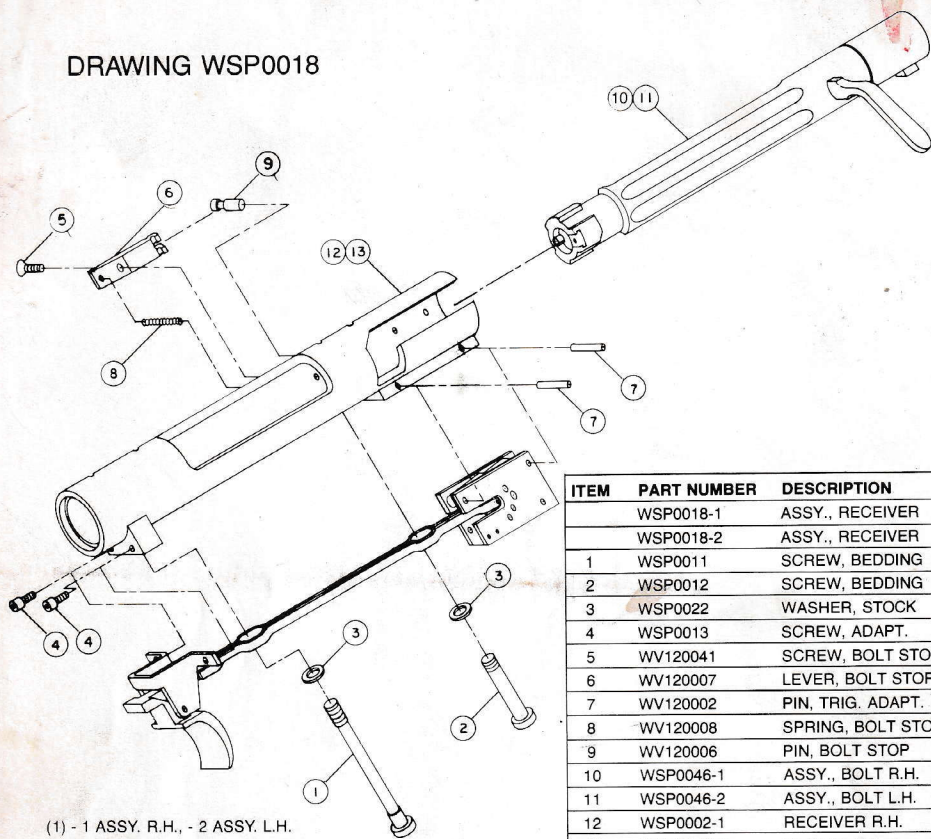

ITEM	PART NUMBER	DESCRIPTION
	WSP0018-1	ASSY., RECEIVER
	WSP0018-2	ASSY., RECEIVER
1	WSP0011	SCREW, BEDDING
2	WSP0012	SCREW, BEDDING
3	WSP0022	WASHER, STOCK
4	WSP0013	SCREW, ADAPT.
5	WV120041	SCREW, BOLT STOP
6	WV120007	LEVER, BOLT STOP
7	WV120002	PIN, TRIG. ADAPT.
8	WV120008	SPRING, BOLT STOP
9	WV120006	PIN, BOLT STOP
10	WSP0046-1	ASSY., BOLT R.H.
11	WSP0046-2	ASSY., BOLT L.H.
12	WSP0002-1	RECEIVER R.H.
13	WSP0002-2	RECEIVER L.H.

DRAWING WSP0020

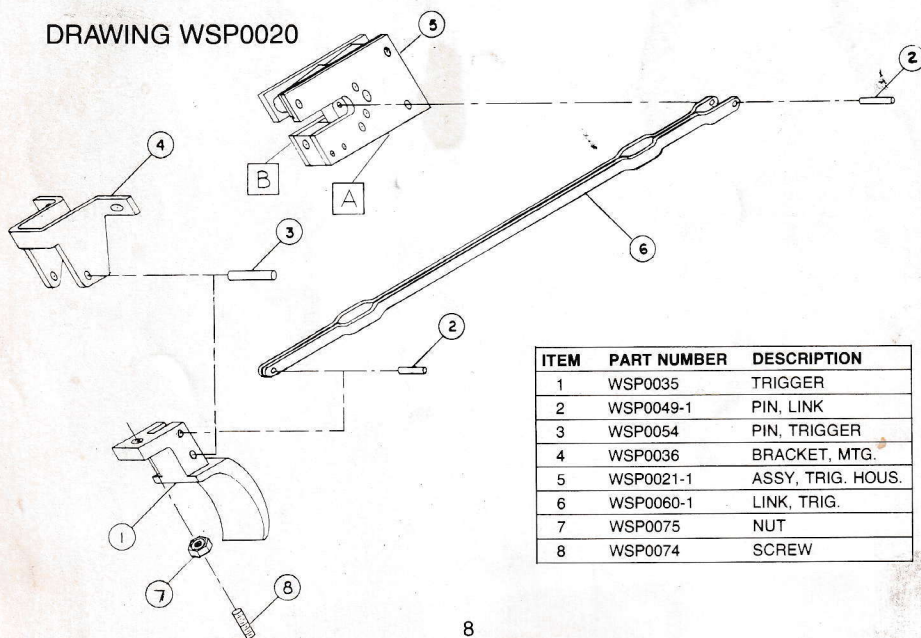

ITEM	PART NUMBER	DESCRIPTION
1	WSP0035	TRIGGER
2	WSP0049-1	PIN, LINK
3	WSP0054	PIN, TRIGGER
4	WSP0036	BRACKET, MTG.
5	WSP0021-1	ASSY, TRIG. HOUS.
6	WSP0060-1	LINK, TRIG.
7	WSP0075	NUT
8	WSP0074	SCREW